

Filter housings for out breathing and make-up air filtration on sterile storage tanks or transport vessels.

Donaldson® P-BE vent filter housings are developed for sterile ventilation of stationary and mobile storage tanks used in food, beverage, pharmaceutical, chemical and other industries. P-BE vent housings:

- Are available in 12 different sizes with flow rates ranging from 1.7 to 2039 m³/hr (1 to 1200 scfm)
- Have MTRs available upon request
- Are offered with Tri-Clamp or ANSI Flange connection
- Have a Tri-Clamp body closure on single element housings and a tie rod closure on multi-element housings for easy element change out



P-BE

CHOOSE THE FILTER TO SUIT YOUR APPLICATION

P-BE vent filter housings are usually used in conjunction with our P-SRF V process sterile air filter element to ensure sterile ventilation with very little pressure drop or air resistance. It can also be used with other filter elements such as LifeTec™ PT N or the P-SRF X to meet your specific requirements.

SPECIFICATIONS

TRI-CLAMP

Model	Housing Material	Gasket	Connection Size	Int. Surface Finish	Maximum Operating Temperature	MTR Included	Element	Part Number
0006	316L SS	EPDM	38 mm (1-1/2")	RA 63	199° C (390° F)	Yes	03/10, UF, Qty 1	AG1252829
0027							05/25, UF, Qty 1	AG1252830
0032			51 mm (2")				05/30, UF, Qty 1	AG1252831
0072							10/30, UF, Qty 1	AG1252832
0144			76 mm (3")				20/30, UF, Qty 1	AG1252833
0192							30/30, UF, Qty 1	AG1252834

FLANGE

Model	Housing Material	Gasket	Connection Size	Int. Surface Finish	Maximum Operating Temperature	MTR Included	Element	Part Number
0006	316L SS	EPDM	25 mm (1")	RA 63	199° C (390° F)	Yes	03/10, UF, Qty 1	AG1252835
0027			38 mm (1-1/2")				05/25, UF, Qty 1	AG1252836
0032							51 mm (2")	05/30, UF, Qty 1
0072			10/30, UF, Qty 1					AG1252838
0144			64 mm (2-1/2")				20/30, UF, Qty 1	AG1252839
0192							30/30, UF, Qty 1	AG1252840
0432	304 SS	N/A	102 mm (4")			No	20/30, UF, Qty 3	1C099413
0576			30/30, UF, Qty 3				1C101574	
0768			30/30, UF, Qty 4				1C102966	
1152			152 mm (6")				30/30, UF, Qty 6	1C102719

DIMENSIONS

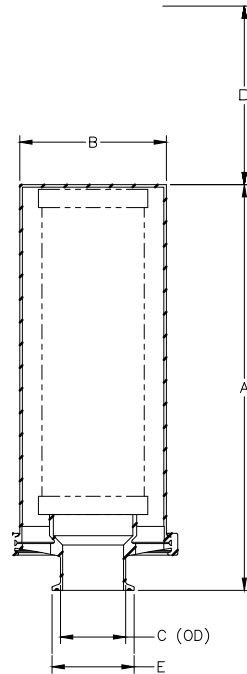

TRI-CLAMP

Model	Capacity		Weight*		Dimensions										Element	Part Number
					A		B		C (Connection Pipe OD)		D (Clearance Height)		E (Connection Flange OD)			
	m ³ /hr	scfm	kg	lbs	mm	inch	mm	inch	mm	inch	mm	inch	mm	inch		
0006	17	10	1.36	3.0	118	4.65	85	3.35	38	1.5	89	3.5	51	1.99	03/10, UF, Qty 1	AG1252829
0027	27	16	2.04	4.5	177	6.98	104	4.09	38	1.5	140	5.5	51	1.99	05/25, UF, Qty 1	AG1252830
0032	41	24	2.27	5.0	200	7.89	114	4.50	51	2.0	165	6.5	64	2.52	05/30, UF, Qty 1	AG1252831
0072	82	48	2.95	6.5	316	12.46	114	4.50	51	2.0	292	11.5	64	2.52	10/30, UF, Qty 1	AG1252832
0144	173	102	5.22	11.5	553	21.77	129	5.08	76	3.0	521	20.5	91	3.58	20/30, UF, Qty 1	AG1252833
0192	258	152	6.80	15.0	808	31.81	129	5.08	76	3.0	775	30.5	91	3.58	30/30, UF, Qty 1	AG1252834

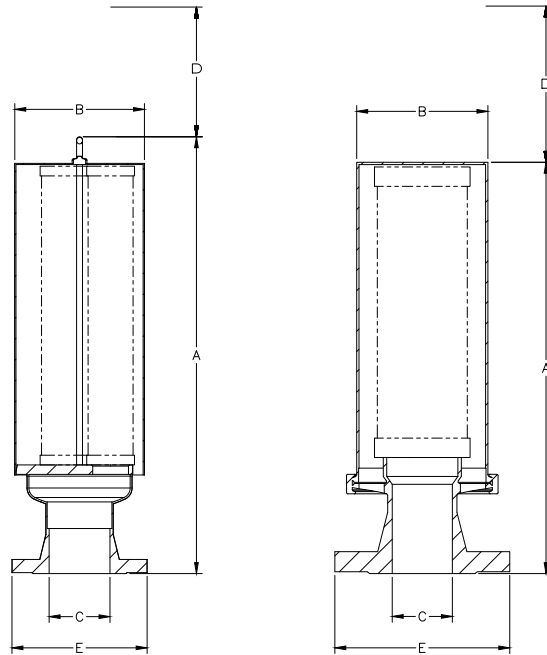

FLANGE

Model	Capacity		Weight*		Dimensions (inches)										Element	Part Number
					A		B		C (Connection Pipe OD)		D (Clearance Height)		E (Connection Flange OD)			
	m ³ /hr	scfm	kg	lbs	mm	inch	mm	inch	mm	inch	mm	inch	mm	inch		
0006	17	10	2.0	4.5	162	6.36	85	3.35	25	1.0	89	3.5	108	4.25	03/10, UF, Qty 1	AG1252835
0027	27	16	3.4	7.5	223	8.78	104	4.09	38	1.5	140	5.5	127	5.00	05/25, UF, Qty 1	AG1252836
0032	41	24	3.6	8.0	236	9.29	114	4.50	38	1.5	165	6.5	127	5.00	05/30, UF, Qty 1	AG1252837
0072	82	48	8.2	18.0	358	14.11	114	4.50	51	2.0	292	11.5	152	6.00	10/30, UF, Qty 1	AG1252838
0144	173	102	9.3	20.5	601	23.67	129	5.08	64	2.5	521	20.5	178	7.00	20/30, UF, Qty 1	AG1252839
0192	258	152	10.9	24.0	856	33.71	129	5.08	64	2.5	521	20.5	178	7.00	30/30, UF, Qty 1	AG1252840
0432	420	247	18.6	41.0	737	29.00	221	8.70	102	4.0	584	23.0	229	9.00	20/30, UF, Qty 3	1C099413
0576	630	371	20.9	46.0	991	39.00	221	8.70	102	4.0	838	33.0	229	9.00	30/30, UF, Qty 3	1C101574
0768	839	494	22.7	50.0	991	39.00	274	10.80	152	6.0	838	33.0	279	11.00	30/30, UF, Qty 4	1C102966
1152	1261	742	35.8	79.0	991	39.00	325	12.80	152	6.0	838	33.0	279	11.00	30/30, UF, Qty 6	1C102719

Important Notice

Many factors beyond the control of Donaldson can affect the use and performance of Donaldson products in a particular application, including the conditions under which the product is used. Since these factors are uniquely within the user's knowledge and control, it is essential the user evaluate the products to determine whether the product is fit for the particular purpose and suitable for the user's application. All products, specifications, availability and data are subject to change without notice, and may vary by region or country.



Donaldson Company, Inc.
Minneapolis, MN

donaldson.com
shop.donaldson.com

Australasia 61-02-4350-2066
marketing.australia@donaldson.com

Brazil 55-11-4894-6035
vendas.brasil@donaldson.com

China 86-400-921-7032
info.cn@donaldson.com

EMEA 49-2129-569-0
cap-europe@donaldson.com

India 91-124-4807-400
indiaenquiries@donaldson.com

Japan 81-42-540-4123
ndl-ultrafilter-web@donaldson.com

Korea 82-2-517-3333
cap-kr@donaldson.com

Latin America 52-449-300-2442
industrialair@donaldson.com

North America 800-543-3634
processfilters@donaldson.com

South Africa 27-11-997-6000
samarketing@donaldson.com

Southeast Asia 65-6311-7373
sea.salesenquiry@donaldson.com